

INUKTUN VERSATRAX 100

OnSite Standard Product



MINIATURE SYSTEM. LONG-RUN INSPECTION.

Eddyfi Technologies' Inuktun Versatrax 100™ is a miniature pipe inspection system with a variety of configurations that can tackle almost any confined space inspection application.

Industries & Applications

- Municipal (Sewer/Water)
- Nuclear
- Oil & Gas (Onshore/Offshore)
- Petrochemical
- Tank Inspection (Internal/External)
- Subsea/Ship Hull Inspection

"The Versatrax 100™ system is without doubt the cutting edge in the CCTV inspection world. Our operators are delighted with the performance and reliability of this next generation system."

— G. Holloway, MSIS Contracts Manager, M S Industrial Services Ltd .

Inspection technology that grows with you

Eddyfi Technologies' Inuktun Versatrax 100™ is a miniature pipe inspection system with a variety of configurations that can tackle almost any confined space inspection application. Offering full modularity, the Versatrax 100 can be arranged either inline for small diameters, in parallel configuration for larger pipes and ductwork. Other configurations are available for this modular and flexible system. Discuss your specific application requirements with your sales representative. With this latest design, you can connect a camera directly to the tether cable, so it also works as a standalone drop camera too. And it is truly portable; the entire system can be packaged in hard shell, industrial carry cases making it easy to transport and quick to setup in almost any environment.

With options that include multiple cameras, longer tethers, advanced reporting software and image enhancement systems, the possibilities are almost endless. Like all Inuktun crawlers, it is simple to use and quick to deploy making it ideal for scheduled or emergency inspections in petrochemical plants, nuclear generating stations, hydro-electric facilities, refineries, ships, and more. The versatility of this robust inspection crawler provides an all-in-one system for small and medium sized pipes, tanks, and boreholes or similar confined spaces where a downhole camera is needed. Best of all the Versatrax 100 is compliant with IM3™ (Inuktun Multi-Mission Modular) technology so you can scale up your capability as your inspection needs evolve.

Parallel



Inline

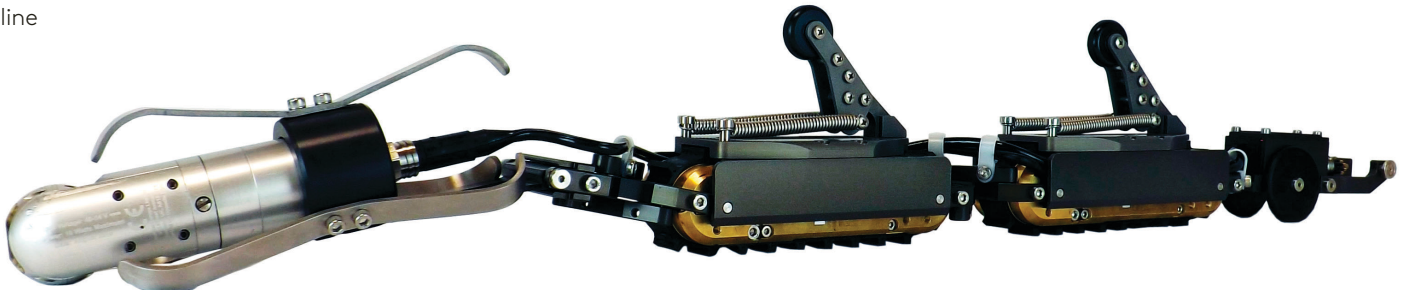

SPECIFICATIONS

KEY SPECIFICATIONS

Depth Rating	60 m (200 ft)
Maximum Tether Length	300 m (1,000 ft)
Maximum Speed	9 m (30 ft) per minute dependent on track type
Vehicle Payload	Up to 4.5 kg (10 lb)
Front Facing Camera	Inuktun Spectrum 45™ Optional: Inuktun Spectrum 90™ (parallel)
Rear Facing Camera	 Inuktun Onyx™ (inline)
Operating Temperature	0 °-50 °C (32 °-122 °F)*
Vehicle Weight	6.8 kg (15 lb) parallel

Minimum Vehicle Dimensions

See drawings below

Standard Components

2 × brass Inuktun Microtracs™
1 × Inuktun Spectrum 45™ camera
Auxiliary LED lights (parallel vehicle)
Weight set (parallel vehicle)
Inline and/or parallel chassis and wiring harness
100 m (330 ft) tether
PC-based controller with ICON™ control and reporting software

The VT100 standard parallel chassis with Spectrum 45™ camera is better suited for horizontal pipe inspection.

*Dependent on operating conditions. Ask your sales expert for more information.



Parallel

Units in inches [mm]

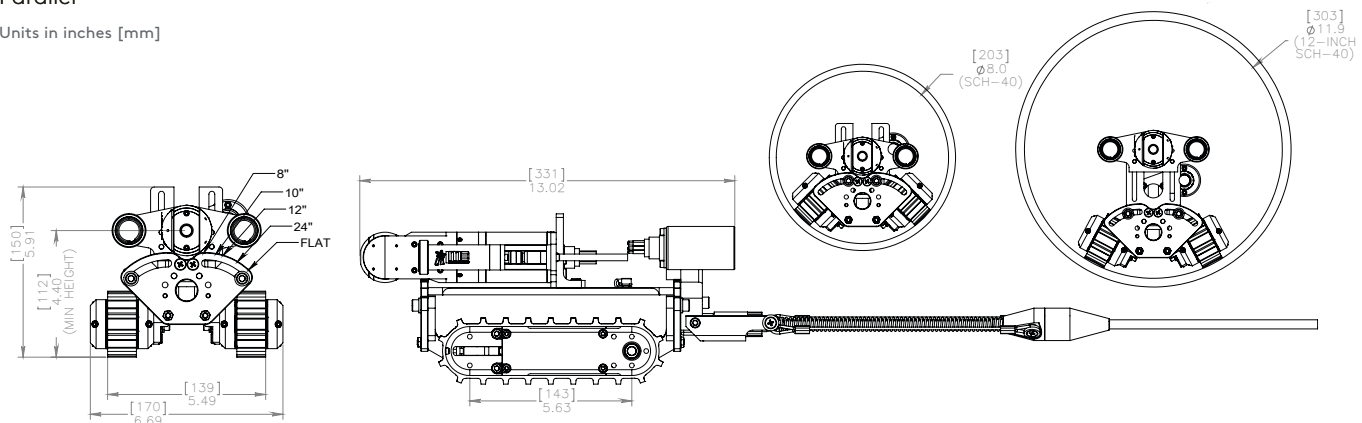

Inline

Units in inches [mm]

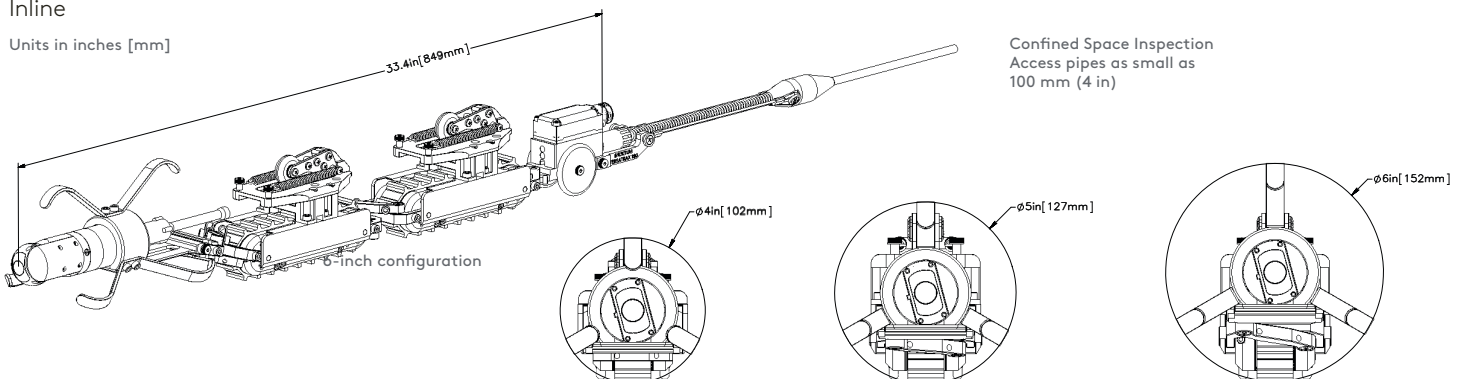

The information in this document is accurate as of its publication. Actual products may differ from those presented herein. © 2020 Eddyfi NDT, Inc. Crystal Cam, IM3, and their associated logos are trademarks or registered trademarks of Inuktun Services Ltd. (wholly owned subsidiary of Eddyfi NDT, Inc.) in Canada and/or other countries. Eddyfi Technologies reserves the right to change product offerings and specifications without notice.

www.eddyfi.com

info@eddyfi.com

